

Sweeper Evacuation System

Product Guide



OVERVIEW

The Sweeper system is designed to automatically remove...



HOW IT WORKS

The material is vacuumed up by a slotted pickup tube that is attached to the...



PRODUCT INFORMATION

View our full technical specification, options and accessories...



CONTACT

Find out your local contacts or where your regional head office is located...

**AUTOMATICALLY
COLLECTS MATERIAL
FROM A CONTAINER
WITHOUT THE NEED
FOR MONITORING**

MAGUIRE®
Intelligent Simplicity

OVERVIEW

Functions and Benefits

The Sweeper system is designed to automatically remove material from a container without the need for human intervention – saving time and overheads.

AUTOMATIC MATERIAL REMOVAL

The sweeper's rotating action moves resin to a slotted pickup tube to be vacuumed out of the container.

REDUCES LABOUR

No one has to manually move the pickup tube because resin is constantly moved to the vacuum point.

ENERGY SAVINGS / EXTENDED MOTOR LIFE

A vacuum switch allows the unit to operate only while your vacuum system is pulling material. Thus, this system is always ready, never has to be manually started or stopped. There is a Jog button to rotate the unit manually.

EASY PLACEMENT OF RESIN CONTAINERS

A pallet jack can move the container into position – no forklift required.

LOWER INSTALLATION AND OPERATION COSTS

The Sweeper requires no compressed air and operates on 115 V electricity, drawing less than 2 amps.



SIGNAL LIGHTS

Lights indicate when the unit is "ON" and when it is rotating.

REDUCES WASTE

Effective material removal keeps resin from being thrown away.

SMALL FOOTPRINT

Footprint is slightly more than the materials container being unloaded.

SAFER THAN A TILT TABLE

The sweeper has no heavy-duty hydraulics with pinch points and low torque and rotation speed provide inherent safety – no guards required.



PRODUCT INFO



Technical Specification

Model Number	Vertical Clearance		Tube Diameter	
	US	Metric	US	Metric
SW-4815	48"	1.2 m	1.5"	38.0 mm
SW-4820	48"	1.2 m	2"	51.0 mm
SW-4825	48"	1.2 m	2.5"	63.5 mm
SW-8415	84"	2.1 m	1.5"	38.0 mm
SW-8420	84"	2.1 m	2"	51.0 mm
SW-8425	84"	2.1 m	2.5"	63.5 mm

Maguire reserves the right to cancel product or change product, product specifications and data without notice to improve reliability, function, design or otherwise.

COMBINE WITH GVL SERIES LOADERS
FOR A COMPLETE MATERIALS
CONTAINER UNLOADING PACKAGE



Options

Stainless Steel Brush Assembly

PART #: OPSW-001 (in lieu of standard)



Accessories

Cover for materials container

PART#: GLC-4848



Interconnected Controls for Dual Sweepers

PART#: OPSW-002

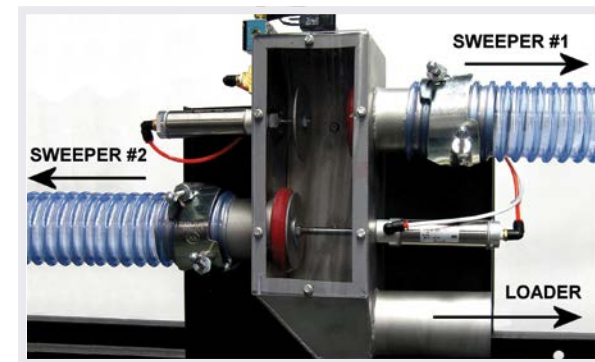

HOW IT WORKS

The Sweeper

The Sweeper gets its name from the fact that it continuously “sweeps” the top level of the contents of the materials container to the outer edges.

The material is vacuumed up by a slotted pickup tube that is attached to the end of a flexible suction hose.

The whole lower section descends and rotates in a way that forces the pickup tube to vacuum up the material without interruption, including the material that is swept into the corners of the container. Ultimately, less than 10 lb of pellets remain.



**SLOW RPM DRIVE IS
ACTIVATED ONLY WHEN
VACUUM LOADING
SYSTEM CALLS FOR
MATERIAL**



**SYSTEM CONSISTENTLY FLATTENS
MATERIAL PILE, PUSHING MATERIAL
TO EDGE OF BOX AND CONVEYED
DIRECTLY**



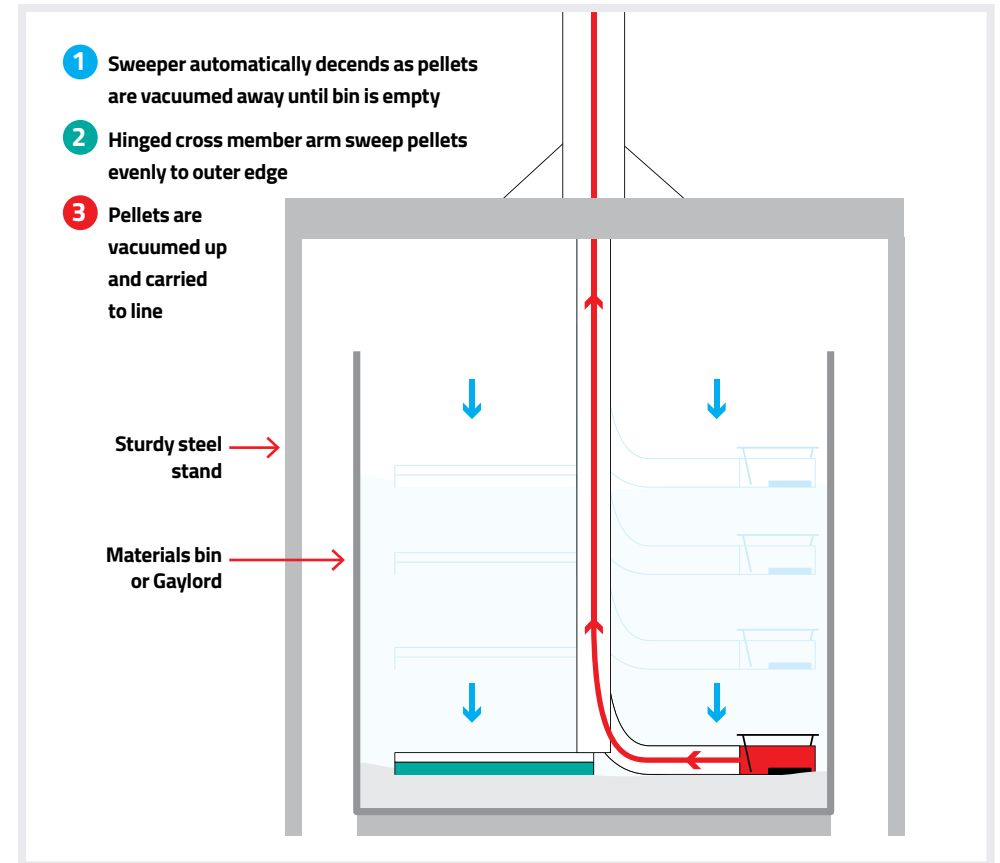
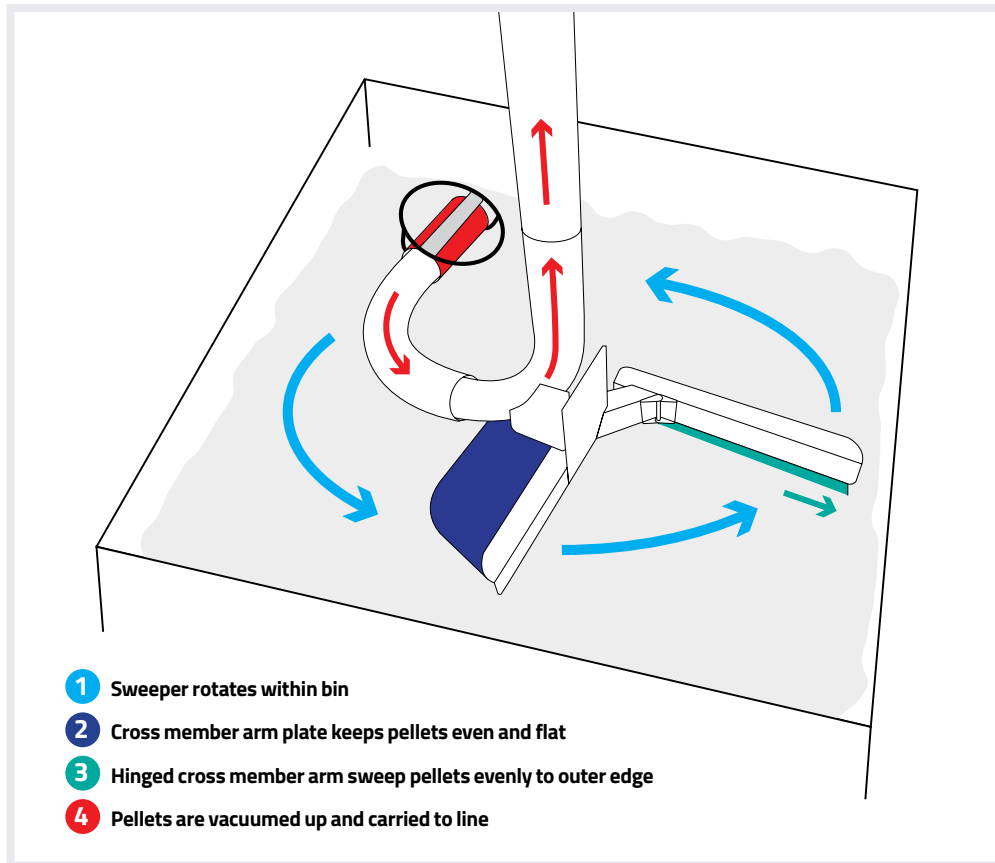

- A sturdy structural steel stand that straddles the materials container allowing easy front access.
- A set of vertical "rails" carry a "trolley" up and down above the materials container.
- The trolley carries a fixed, standard 1.5" (38mm) 2" (50mm) 2.5" (63.5mm) aluminum material conveying tube, and is coupled to a second tube below, that rotates.

- The lower rotating tube is driven by a gear motor, at about 1 RPM.
- A 3 ft (1m), flexible vacuum hose has a short slotted pick up tube at the end to effectively vacuum up the pellets.
- Pellets in the center are "swept" to the outside by a cross member, that serves as the "sweeper".

- As the vertical tube rotates, the flexible portion is dragged across the top of the pellets, in a swept back trailing manner, reaching into each corner and repeatedly vacuuming pellets from the sides and corners.
- A counter balanced spring-loaded cable prevents the weight of the trolley from becoming buried in the resin.

Maguire 5D – watch our products come to life

Download our Maguire 5D app and explore our WSB blender, VBD Vacuum Dryer and Liquid Colour products in a more detailed experience. Available at Android and iOS stores – just search for **Maguire 5D**.

For printable targets for these products, refer to our **Maguire 5D** webpage and start exploring NOW: <http://www.maguire.com/page.php/5d.htm>

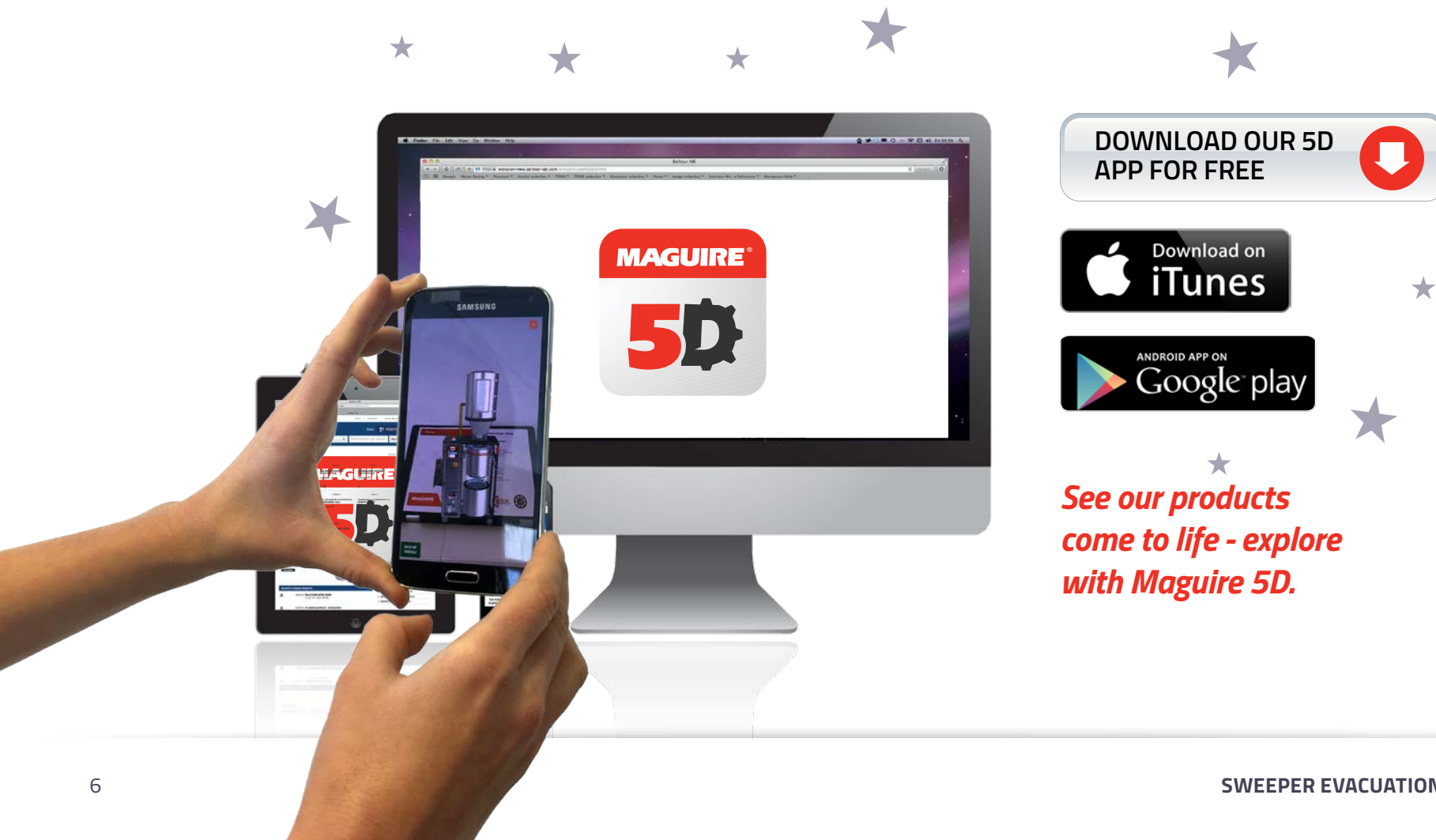

*See our products
come to life - explore
with Maguire 5D.*



MAGUIRE OFFICES AND WAREHOUSES

Maguire USA

Aston, PA, USA
T: +1 610 459 4300
F: +1 610 459 2700
E: info@maguire.com

Maguire Canada

Ontario, Canada
T: +1 905 879 1100
F: +1 905 879 1101
E: info@maguirecanada.com

Maguire Europe

Staffordshire, UK
T: +44 1827 338 280
F: +44 1827 338 285
E: info@maguire-europe.com

Maguire IMEA

Dubai, UAE
T: +971 4 881 6700
E: info@maguire-imea.com

Maguire Asia

Singapore
T: +65 6848 7117
F: +65 6542 8577
E: magasia@maguire-products.com.sg

Maguire China

Beijing
T: +86 21 5882 3410
F: +86 21 5882 3420
E: amber@maguirechina.com

www.maguire.com

MAGUIRE[®]
Intelligent Simplicity



@MaguireProducts



Maguire-Products

info@maguire.com

www.maguire.com